

No Truss Bridges or Concrete/Masonry Arches on this Map

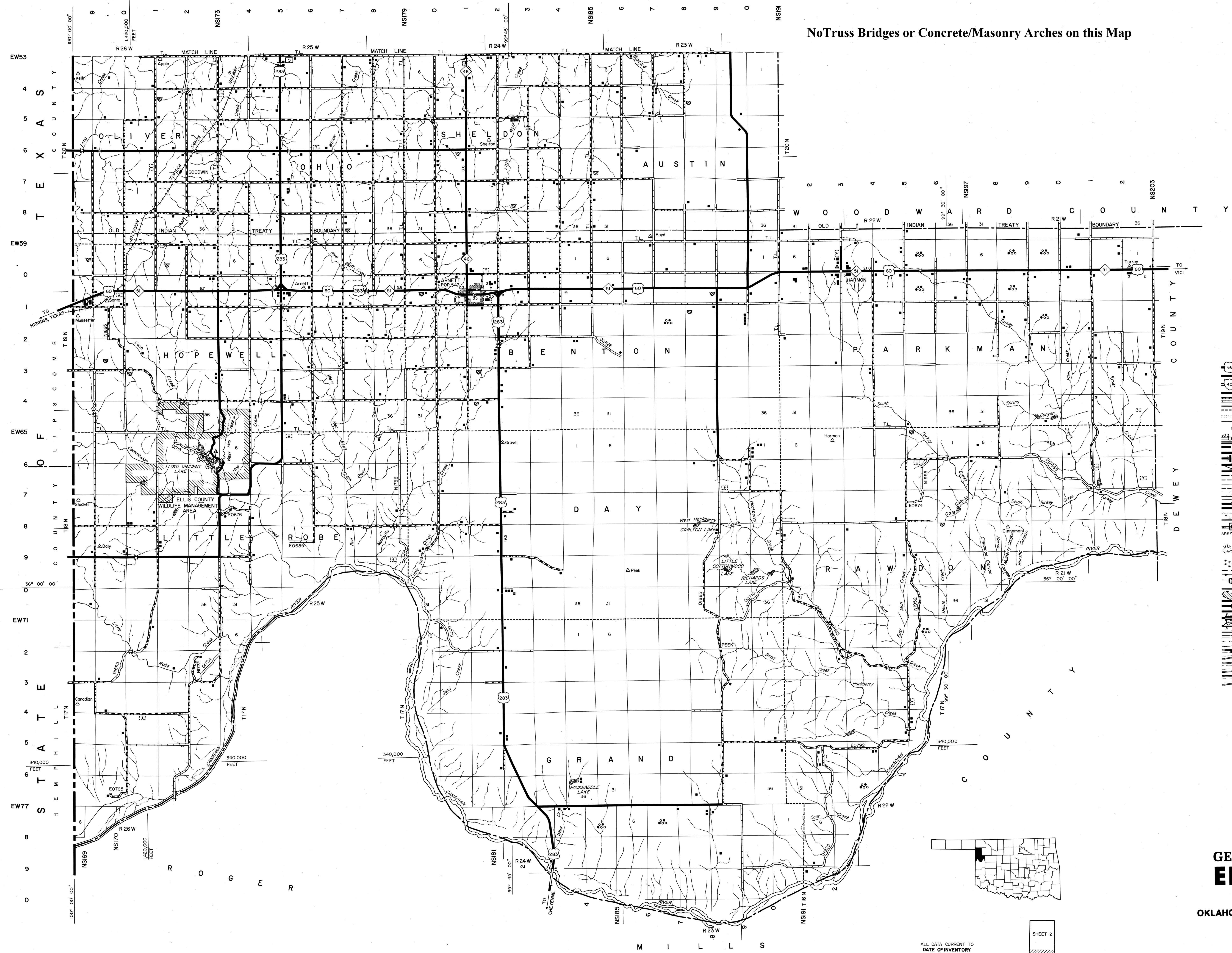

LEGEND

- U.S. NUMBERED HIGHWAY
- STATE NUMBERED HIGHWAY
- INTERSTATE HIGHWAY ROUTE
- PAVED ROAD
- GRAVEL ROAD
- GRADES & GRADED ROAD
- UNIMPROVED ROAD
- PRIMITIVE ROAD
- PROJECTED ROAD
- RESIDENTIAL ROAD
- COUNTY ROAD ID NO.
- MILEAGE BETWEEN POINTS
- DIVIDED HIGHWAY, 4 OR MORE LANES
- UNDIVIDED HIGHWAY, 3 OR MORE LANES
- TRAFFIC CIRCLE
- HIGHWAY GRADE SEPARATION
- TRAFFIC INTERCHANGE
- STATE LINE
- COUNTY LINE
- CIVIL TOWNSHIP LINE
- RURAL DEVELOPMENT AREA
- GOVERNMENT PROPERTY LINE
- MATCH LINE
- COUNTY SEAT
- TOWN CENTER
- CORPORATE LIMITS
- CIVIL TOWNSHIP ROAD IN PLACE
- INSET BOUNDARY
- ELEVATION ABOVE SEA LEVEL
- MOUNTAIN RANGE, BUTTE OR MESA
- SMALL MONUMENT
- MARSH OR SWAMP LANDS
- DRAINAGE DITCH
- IRRIGATION DITCH
- LAKE, RESERVOIR OR POND WITH DAM
- ROAD OVER DAM
- DRY LAKE SUBJECT TO FLOOD
- SMALL BRIDGES CLOSELY SPACED
- HIGHWAY BRIDGE, OVER 20 FT. IN LENGTH
- GENERAL BRIDGE, LONG CROSSING
- ARCH BRIDGE
- TRUSS BRIDGE, W-Wood, S-Steel, C-Concrete
- CONCRETE DIP OR FORD
- FORD ROAD ESTABLISHED
- INTERMITTENT STREAM
- NARROW STREAM
- DOCK PIER OR LANDING
- NAVIGABLE STREAM WITH LOCK & DAM
- WIDE STREAM OR RIVER
- TRIANGULATION STATION
- RAILROAD, ANY NUMBER OF TRACKS
- RAILROAD WITH STATIONS INDICATED
- GRADE CROSSING
- UNDERPASS, R.R. ABOVE
- OVERPASS, R.R. BELOW
- RAILROAD ON STREET
- MILITARY AIRFIELD
- AIRPORT WITH COMPLETE FACILITIES
- AIRPORT WITH LIMITED FACILITIES
- LANDING STRIP, PRIVATE FIELD
- AIRPORT, GENERAL, OUTLINE OF FIELD
- RUNWAYS SHOWN IN POSITION
- ROADSIDE PARK, Picnic Grounds
- PLAYGROUND
- BATHING BEACH OR SWIMMING POOL
- SCENIC SITE
- MOTEL
- CAMP OR LODGE, Permanent With Buildings
- SMALL PARK
- SP-Municipal, TP-Trailer Park
- FOREST RANGER STATION
- OBSERVATION OR LOOKOUT TOWER
- CAMP SITE
- FISH HATCHERY
- GOLF COURSE OR COUNTRY CLUB
- ATHLETIC FIELD OR AMUSEMENT PARK
- FAIRGROUNDS, RACE COURSE
- DWELLING
- NUMBER OF DWELLINGS CLOSELY SPACED
- COMBINED BUSINESS AND DWELLING
- POST OFFICE
- POST OFFICE COMBINATIONS
- SEASONAL DWELLINGS
- CHURCH OR OTHER RELIGIOUS BUILDING
- CEMETERY
- CHURCH WITH CEMETERY ADJACENT
- REST HOME
- HOSPITAL
- SMALL BUSINESS
- INDUSTRY
- SAW MILL
- WATER TOWER
- GAUGING OR PUMPING STATION
- WAREHOUSE
- GRAVEL PIT
- QUARRY
- SCHOOL
- COMMUNITY HALL OR LODGE
- DRIVE-IN THEATER
- CORRECTIONAL INSTITUTION
- HIGHWAY GARAGE
- JUNK YARDS & DUMPS
- A-Automobile, B-School Building Material, D-Refuse, Garbage or Trash Dump, F-Sewage, G-Other
- SEWAGE DISPOSAL PLANT
- WATER SUPPLY, STAND PIPE
- POWER PLANT
- BOOSTER STATION
- POWER SUBSTATION
- TELEVISION OR RADIO STATION
- MILITARY INSTALLATION

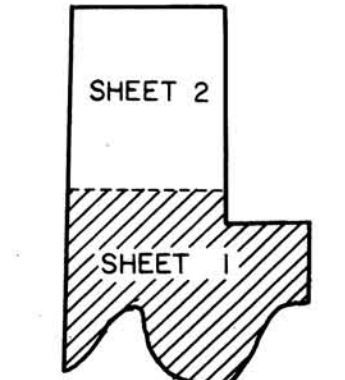
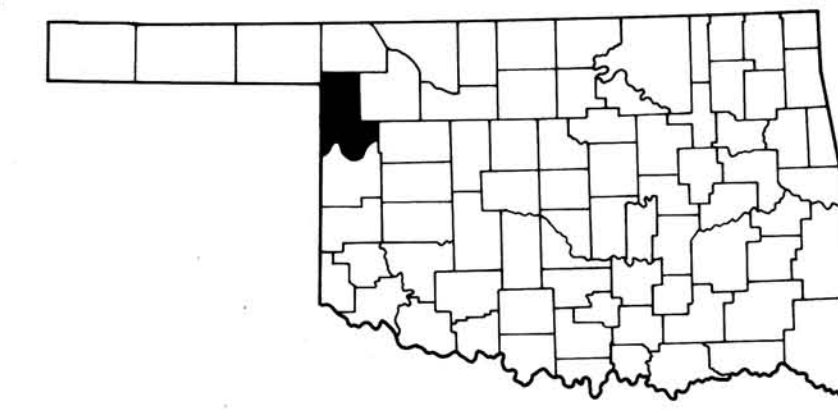
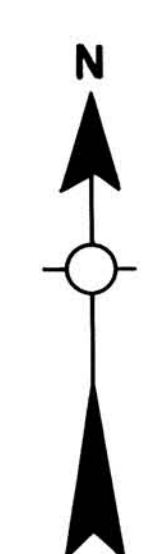

GENERAL HIGHWAY MAP ELLIS COUNTY OKLAHOMA

PREPARED BY THE
OKLAHOMA DEPARTMENT OF TRANSPORTATION
PLANNING DIVISION

IN COOPERATION WITH THE
U.S. DEPARTMENT OF TRANSPORTATION
FEDERAL HIGHWAY ADMINISTRATION

SCALE
0 1 2 3 4 5 MILES

ALL DATA CURRENT TO
DATE OF INVENTORY
APRIL 1987
ORIGINAL DRAFTING BY W.T. FEB. 1989
STATE SYSTEM REVISED TO JAN. 1992

This map indicates those roads known to the Department to be open to public travel. Placement of a road on this map has no relationship to maintenance responsibility by any level of government.
Copies of this map are available for public use at nominal cost.
Address: OKLAHOMA DEPARTMENT OF TRANSPORTATION
REPRODUCTION BRANCH Phone (405) 521-2386
200 N.E. 21st STREET
OKLAHOMA CITY, OKLAHOMA 73105

NOT FOR RESALE

SHEET 1 OF 2 SHEETS

GENERAL HIGHWAY MAP ELLIS COUNTY OKLAHOMA